

| | | | | | | | | | | |
|---|---|---|---|---|---|-----|-----|-------------|------|----------|
| A | B | C | D | E | F | G | H | I | J | |
| | | | | | | ECN | REV | DESCRIPTION | DATE | APPROVED |

Part number

GL25-9TR-20S*

Model:Indicates the HR25 Series

Shell size:Indicates the outer diameter of the engaging portion of the Plug

Classification of lock mechanism:Indicated as described below

T:Screw lock system No symbol:Push-pull lock system

Classification of shell P:Plug J:Jack R:Receptacle

Number of contacts

Form of contacts:As described below

P:Male contacts S:Female contacts

Type of contacts:The wiring system used or the type of contacts are classified in alphabetical order:

Example None:Solder termination

C:Crimp-style contacts

A:PCB dip termination

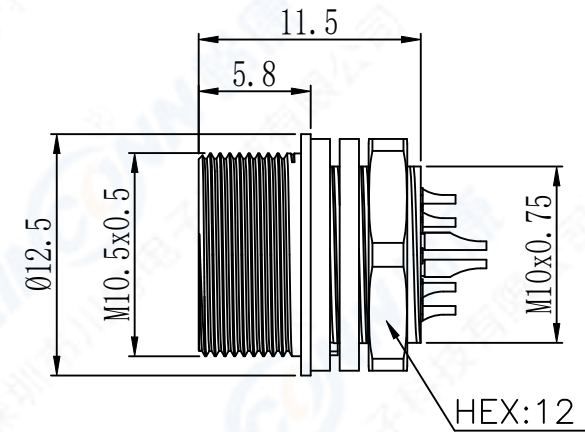
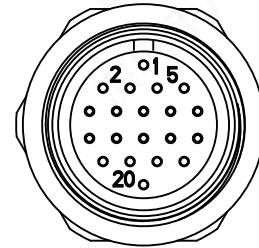

| Shell size | 9 size | | |
|---------------------|---------------------|----|----|
| Contact arrangement | | | |
| NO. of pins | 12 | 16 | 20 |
| Withstand voltage | 100V AC for 1minute | | |
| Current capacity | 1A | | |
| Contact resistance | 30mΩ | | |

Recommended mounting hole

Mounting hole dimension shown here is tight by hexagon nut from back side.

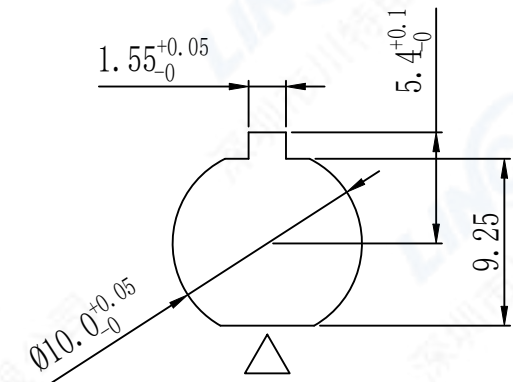

| | |
|---|---|
| 5 | 母针/Female pin: 磷铜镀金/Phosphor copper,gold plated |
| 4 | 绝缘体/Insulator:PA66+GF, Black |
| 3 | 垫圈/Locking washer: 不锈钢/Stainless Steel |
| 2 | 六角螺母/Hexagonal nut: 黄铜镀镍/Brass,Nickel plated |
| 1 | 外壳/Shell:锌合金镀镍/Zinc alloy Nickel Plated |

| | | | |
|---------|-----------|------------------------------|------------|
| | SCALE | TOLERANCES ARE: DECIMALES | |
| | F | ANGLES | |
| SHEET | DIMENSION | · X± 0.3 | · XX± 0.15 |
| 1 OF 1 | MM | APPROVALS | DATE |
| DWG NO. | REV. | APPROVED: | |
| GL25 | A0 | CHECKED: | |
| | | CHECKED: | |
| | | DRAWN: pengsen | 08/12/2022 |

| | |
|--------------------------------|--------|
| TITLE: Receptacle(Solder type) | |
| PART NO. GL25-9TR-**S | REV. * |
| Linconn Elc Tech Co.,LTD | |