

ECN	REV	DESCRIPTION	DATE	APPROVED

1) 3B系列推拉自锁连接器简介

3B series connectors provide the following main features:

- security of the Push-Pull self-latching system -multipole types 2 to 32 contacts
- solder, crimp or print contacts (straight or elbow) -high packing density for space savings
- multiple key options to avoid cross mating -keying system (<G>key standard) of similar connectors for connector alignment
- 360° screening for full EMC shielding.

2) 技术特性/Technical Characteristics

使用环境/Environment: 室内/Indoor
 接口密封/Ingress protection: IP50
 温度等级/Rated Temperature: -25°, +150°
 寿命/Durability: >500 mate/unmate cycles
 盐雾/Corrosion Resistance: Salt spray test>144h

3) 編碼原則/Part Number

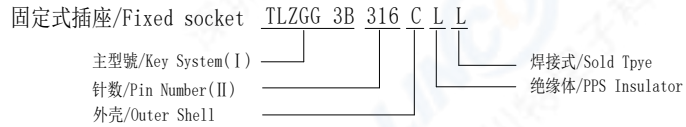

4) 編碼說明/Part number example

定位銷/Key System (I)

KEY LAYOUT	鍵位/Key Type	G	A	B	C	D	E	F	J	K	L
	鍵位/Key	1	2	2	2	2	2	2	2	2	2
	外殼型號/Type	TLZGG	TLZGA	TLZGB	TLZGC	TLZGD	TLZGE	TLZGF	TLZGJ	TLZGK	TLZGL
	角度/Angle	0°	30°	45°	60°	95°	120°	145°	37.5°	52.5°	70°
		/		α		γ	β		α		γ

針數/Pin Number (II)

系列/Series	302	303	304	305	306	307	308	309	310	312
孔位排列/Pin Number										
導體直徑/Pin size	3.0mm	2.0mm	2.0mm	1.6mm	1.6mm	1.6mm	1.3mm	1.3/2.0mm	1.3mm	0.9mm
適配線纜/Conductor size	12AWG	16AWG	16AWG	18AWG	18AWG	18AWG	20AWG	20/16AWG	20AWG	22AWG
額定電流/Rated current	35A	25A	19A	19A	17A	15A	13A	/	12A	9A

系列/Series	314	316	318	320	322	324	326	330	332
孔位排列/Pin Number									
導體直徑/Pin size	0.9mm	0.9mm	0.9mm	0.7mm	0.7mm	0.7mm	0.7mm	0.7mm	0.7mm
適配線纜/Conductor size	22AWG	22AWG	22AWG	22AWG	22AWG	22AWG	22AWG	22AWG	22AWG
額定電流/Rated current	9A	8A	7A	6A	5.5A	4A	4A	3.5A	5.0A

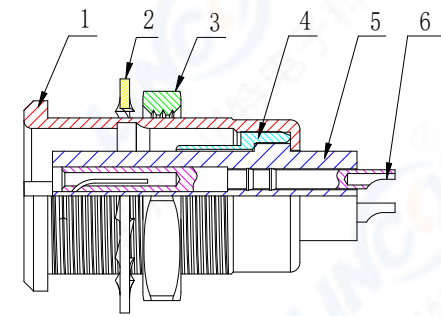
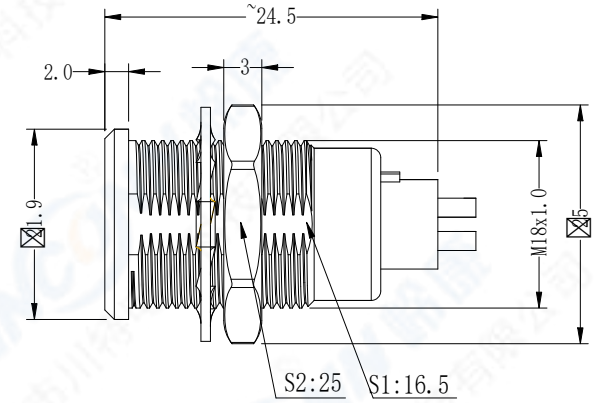
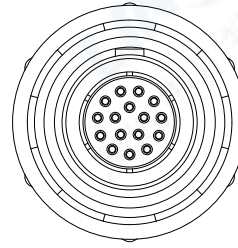

5) 面板開孔尺寸/Hole Size

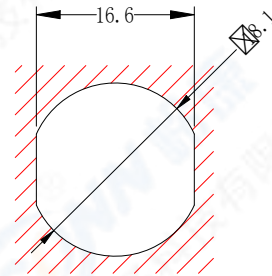

6	母針芯/Pin: 磷銅鍍金/Phosphor copper, Gold plated
5	絕緣體/Insulator: PPS
4	接地環/Earthing crown: 黃銅鍍鎳/Brass, Nickel plated
3	六角螺母/Hexagonal nut: 黃銅鍍鎳/Brass, Nickel plated
2	墊圈/Locking washer: SUS 301
1	外殼/Outer Shell: 黃銅鍍鎳/Brass, Chrome plated
序號 ITEM	名稱 & 規格/Name & DESCRIPTION

	SCALE	TOLERANCES ARE:	
	F	DECIMALES	ANGLES
SHEET	DIMENSION	$x \pm 1$	\pm
1 OF 1	MM	$x \pm 0.5$	
DWG NO.	REV.	APPROVALS	DATE
TLZGG3B	A0	APPROVED:	
		CHECKED:	
		CHECKED:	
		DRAWN: pengsen	05/17/2022

TITLE: 固定式插座/Fixed socket	
PART NO. TLZGG. 3B. 3xx. CLL	REV. *
LINCONN Linconn Elc Tech Co.,LTD	